

PROPOSED PARTLY GROUND + 5 & PARTLY PARKING + 5 STORED (STORIED RESIDENTIAL CUM COMMERCIAL (MERCANTILE RETAIL) BUILDING AT JYOTINAGAR, NEAR WBSDC OFFICE, SILIGURI, WNO- 41 (SMC), DIST. DARJEELING (WB)

OWNER
VISHWAKARMA CREATIONS
REP. BY SRI DEEPAK KUMAR AGRAWALA

LAND SCHEDULE
DARGGRAM
PLOT NO. 02
SHEET NO. 35 L.R. 08 (R.S.)
PARGANA. 31 L.R. 209 (R.S.)
WARD NO. 41 (SMC)
DIST. BHAKTINAGAR
JALPAIGURI

SCHEDULE OF OPENINGS

MKD.	SIZE	SILL	LINTEL
D	1050-2100	2100	2100
D1	900-2100	2100	2100
D2	750-2100	2100	2100
SD	3000-3100	2100	2100
W1	1800-1350	750	2100
W2	1500-1200	900	2100
V	600-900	1200	2100
C.G.	1500-1350	750	2100
GW	1200-1350	750	2100
R.S.	AS REQUIRED		

** ARTIFICIAL LIGHTING & MECHANICAL VENTILATION PROVIDED AS PER THE LATEST PROVISION OF NATIONAL BUILDING CODE OF INDIA.

DECLARATION BY OWNER
I/WHO HEREBY DECLARE THAT THE BUILDING PROPOSED FOR CONSTRUCTION SHALL BE SUPERVISED BY THE LIA. L.S. ENGINEER AS PER THE PROVISIONS OF NATIONAL BUILDING CODE OF INDIA AND AS APPROVED BY THE AUTHORITY.

VISHWAKARMA CREATIONS
PARTNER
Signature of Owner

DECLARATION BY GEO-TECHNICAL ENGINEER
I/WHO HEREBY CERTIFY THAT THE FOUNDATION AND THE SUPERSTRUCTURE OF THE BUILDING PROPOSED FOR CONSTRUCTION ON PLOT NO. 02, L.R. 08 (R.S.) PARGANA, 31 L.R. 209 (R.S.) DIST. BHAKTINAGAR, JALPAIGURI, WB, INDIA, HAS BEEN PERSONALLY INSPECTED BY ME AND WILL MAKE SUCH FOUNDATION AND SUPERSTRUCTURE IS SAFE IN ALL RESPECTS FOR THE PROPOSED BUILDING UNDER THE CONDITIONS AS SPECIFIED IN THE FOUNDATION AND SUPERSTRUCTURE DRAWINGS AND AS APPROVED BY THE AUTHORITY. I AM NOT RESPONSIBLE FOR THE CONSTRUCTION OF THE BUILDING UNLESS I AM CONFINED TO ALL STRUTATION OF ALL RELEVANT IS CODE OF PRACTICE A NATIONAL BUILDING CODE OF INDIA.

Somenendra Bhadra
Class-1
SAC
487, Bidan Road, Siliguri
Ph. No. 97330-45915
e-mail- sbhadra68@gmail.com

Signature of Geotechnical Engineer

SOLIMEN ADAK
Structural Engineer, Class-1
SAC
E-MAIL ID- subrataashish@rediffmail.com
Mob. No. 9310323487

Signature of Structural Engineer

DECLARATION BY L.S.A.B.A.
I/WHO HEREBY CERTIFY THAT THE PLANS, ELEVATION AND SECTIONS AND OTHER STRUCTURAL DETAILS OF THE PROPOSED BUILDING ON PLOT NO. 02, L.R. 08 (R.S.) PARGANA, 31 L.R. 209 (R.S.) DIST. BHAKTINAGAR, JALPAIGURI, WB, INDIA, HAVE BEEN PREPARED IN CONFORMITY WITH ALL RELEVANT PROVISIONS UNDER THE ARTIFICIAL LIGHTING, MECHANICAL VENTILATION AND ELECTRICAL CODES OF PRACTICE AS SPECIFIED IN THE FOUNDATION AND SUPERSTRUCTURE DRAWINGS AND AS APPROVED BY THE AUTHORITY. I AM NOT RESPONSIBLE FOR THE CONSTRUCTION OF THE BUILDING UNLESS I AM CONFINED TO ALL STRUTATION OF ALL RELEVANT IS CODE OF PRACTICE A NATIONAL BUILDING CODE OF INDIA.

Signature of L.S.A.B.A.

Subrata Majumdar
Consultant Engineer

PRITAM DEY (B. Arch.)
Consulting Architect
CA/2006/29976

Signature of L.S.A.B.A.

TITLE: TYPICAL FLOOR PLAN
SCALE: AS SHOWN
SHEET NO. 02/03

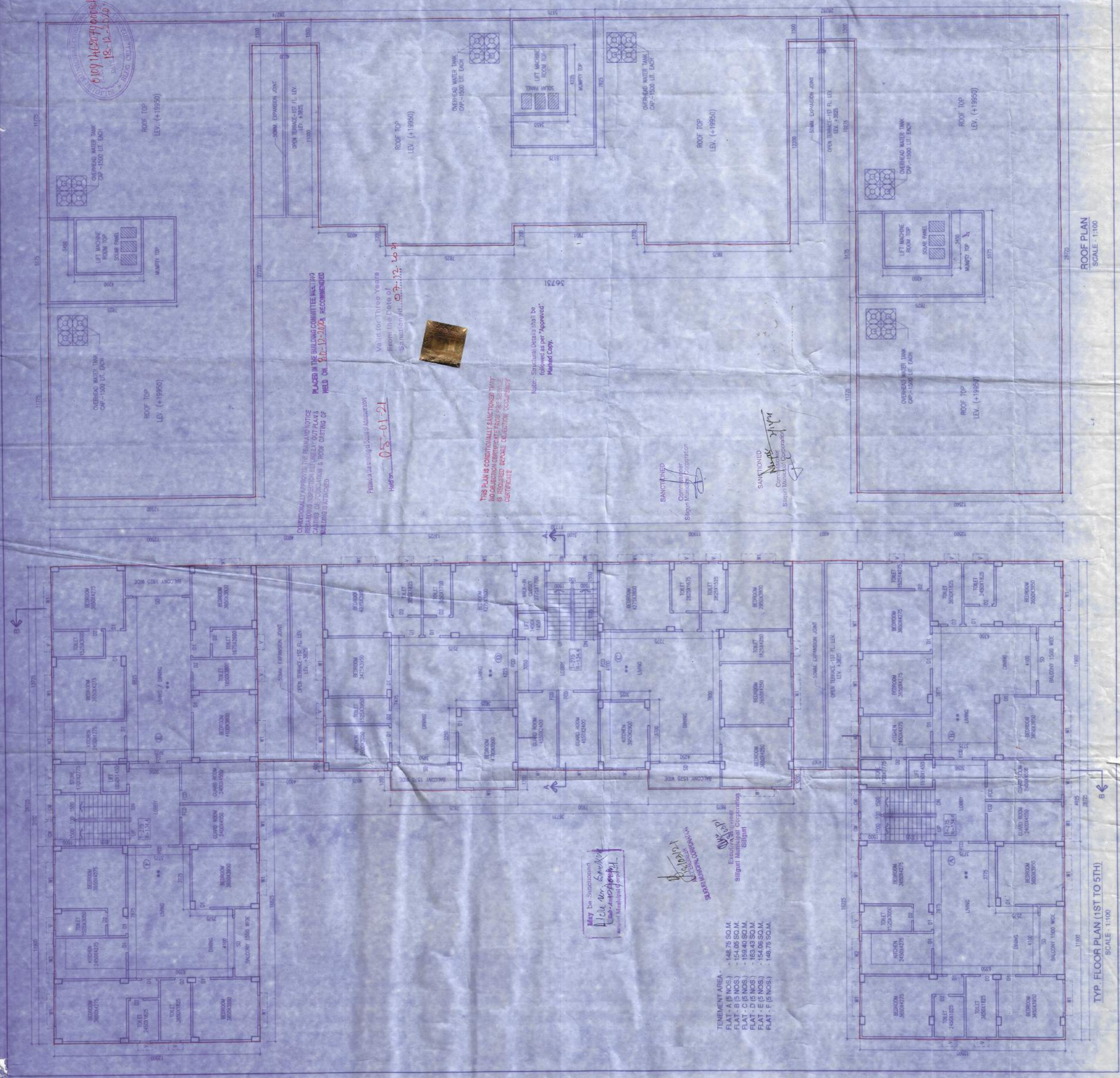

ROOF PLAN
SCALE - 1:100

TYP. FLOOR PLAN (1ST TO 5TH)
SCALE - 1:100